

序号	品名	材质
①	0.5无盖立式胶芯(H4.0)	LCP UL94V-0 本色
②	0.5无盖立式端子(H4.0)	铜合金/表面镀锡
③	0.5无盖立式焊片(H4.0)	铜合金/表面镀锡

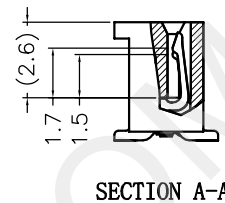

CKT	A	B	C	CKT	A	B	C
4	1.5	2.6	5.0	33	16.0	17.1	19.5
5	2.0	3.1	5.5	34	16.5	17.6	20.0
6	2.5	3.6	6.0	35	17.0	18.1	20.5
7	3.0	4.1	6.5	36	17.5	18.6	21.0
8	3.5	4.6	7.0	37	18.0	19.1	21.5
9	4.0	5.1	7.5	38	18.5	19.6	22.0
10	4.5	5.6	8.0	39	19.0	20.1	22.5
11	5.0	6.1	8.5	40	19.5	20.6	23.0
12	5.5	6.6	9.0	41	20.0	21.1	23.5
13	6.0	7.1	9.5	42	20.5	21.6	24.0
14	6.5	7.6	10.0	43	21.0	22.1	24.5
15	7.0	8.1	10.5	44	21.5	22.6	25.0
16	7.5	8.6	11.0	45	22.0	23.1	25.5
17	8.0	9.1	11.5	46	22.5	23.6	26.0
18	8.5	9.6	12.0	47	23.0	24.1	26.5
19	9.0	10.1	12.5	48	23.5	24.6	27.0
20	9.5	10.6	13.0	49	24.0	25.1	27.5
21	10.0	11.1	13.5	50	24.5	25.6	28.0
22	10.5	11.6	14.0	51	25.0	26.1	28.5
23	11.0	12.1	14.5	52	25.5	26.6	29.0
24	11.5	12.6	15.0	53	26.0	27.1	29.5
25	12.0	13.1	15.5	54	26.5	27.6	30.0
26	12.5	13.6	16.0	55	27.0	28.1	30.5
27	13.0	14.1	16.5	56	27.5	28.6	31.0
28	13.5	14.6	17.0	57	28.0	29.1	31.5
29	14.0	15.1	17.5	58	28.5	29.6	32.0
30	14.5	15.6	18.0	59	29.0	30.1	32.5
31	15.0	16.1	18.5	60	29.5	30.6	33.0
32	15.5	16.6	19.0				

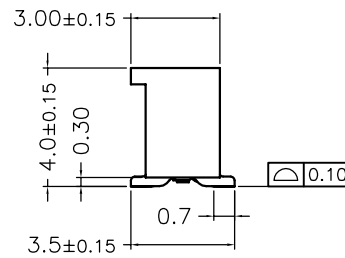
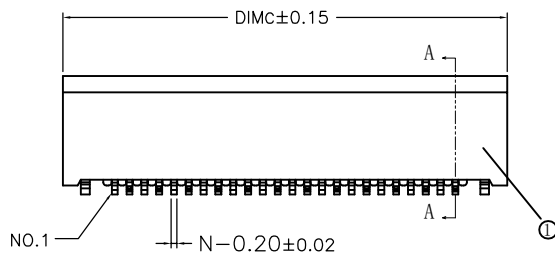
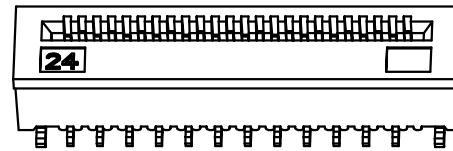
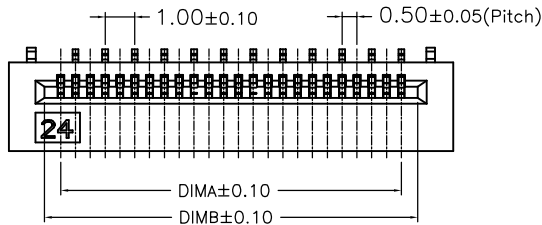
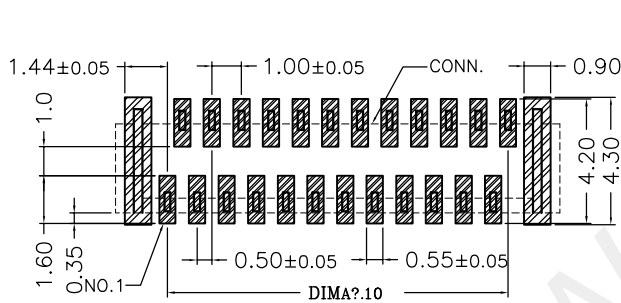
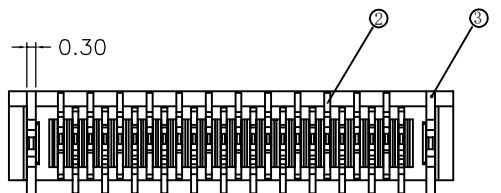

适用线路板 (PCB LAYOUT)

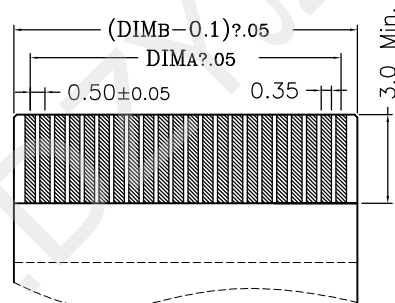

适用扁平线 (Applicable Flat Cable)

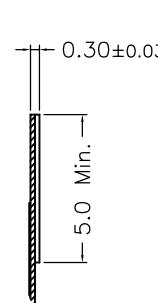

技术指标:

1. 塑件表面应光洁、无毛边、无明显收缩、缺陷、裂纹等现象。
2. 温度范围: -25°C~+85°C。
3. 额定电压: 50V, AC/DC(等效)。
4. 接触电阻: ≤0.03Ω。
5. 绝缘电阻: ≥500MΩ。

## 深圳市华宇创精密电子有限公司

<b>TOLERANCE:</b> X.X ±0.30 X.XX ±0.25 X.XXX ±0.15 X' ±2' X.X' ±0.5'	DRAWN BY : 陈一鸣	DATE : 2014-02-23	PART NAME: 0.5PH 无锁立式贴片正向 FPC
	CHECKED BY: 马跃	DATE : 2014-02-23	PART NO. : HVC1E10-05FPCXX-390
UNIT: mm [inch] SCALE:1:1 SIZE: A4	APPROVED BY: 邱敏	DATE : 2014-02-23	DRAW NO. : HVC-2111011516
			SHEET NO. : 1 OF 1